

NTEP's News for You

In This Issue

[Warm-Season Grass
Final Reports Online](#)
[New Trials for 2014](#)
[Update on new 2013
trials](#)
[National Arboretum
turf exhibit and Grass
Roots update](#)

Quick Links

[News](#)
[More On Us](#)

Join Our List

[Join Our Mailing List!](#)

Volume 4, Issue 3

December 2013

Dear Kevin,

In the midst of the 2013 Holiday Season, we at NTEP wish you a wonderful and blessed time with family and friends, as well as a Happy New Year!

We hope and pray for a prosperous 2014 for each of you, with good health and fortune. In the meantime, enjoy the next couple of weeks, a winter break, and recharge your mind and body for 2014!

Please keep in touch with us via social media. And if we can help you in any way, please feel free to [contact us!](#)

Like us on **Facebook** 

Follow us on **twitter**



WARM-SEASON GRASS FINAL REPORTS ONLINE

Five years of data from seashore paspalum, st. augustine and zoysiagrass is now available

If you are looking for data on a new warm-season species that you may want to try in 2014, we have information for you! Five years of data on seashore paspalum, st. augustinegrass and zoysiagrass is now

available [under our latest data link](#). In addition, data for bermudagrass will be available very soon....just watch the link above!

NEW TRIALS FOR 2014 - WE NEED YOUR HELP!

New bentgrass and fineleaf fescue trials are being planned

With our current bentgrass (putting green and fairway/tee) and fineleaf fescue trials coming to completion in 2013, NTEP is planning new trials of both species for planting in fall 2014. The initial planning for these new trials has started, but **we need your help**.

Customer surveys for the three trials are now in place and we would love to have your feedback! If you have any interest in the evaluation of bentgrass and/or fineleaf fescue, please go to the links below and complete these surveys. Your input received through these surveys is used extensively in planning trial locations, evaluation data to collect, traits to evaluate, trial management levels, etc. The information that you want to know about new cultivars you may purchase in the future will come from the evaluation of these trials. Therefore, help us to get that information right!

We look forward to hearing from you! Thanks in advance for your help!

[2014 NTEP Bentgrass Putting Green Trial Survey](#)

[2014 NTEP Bentgrass Fairway/Tee Trial Survey](#)

[2014 NTEP Fineleaf Fescue Trial Survey](#)



Fine Fescue cultivars displaying fewer weeds, five years after establishment with no supplemental irrigation or pest control

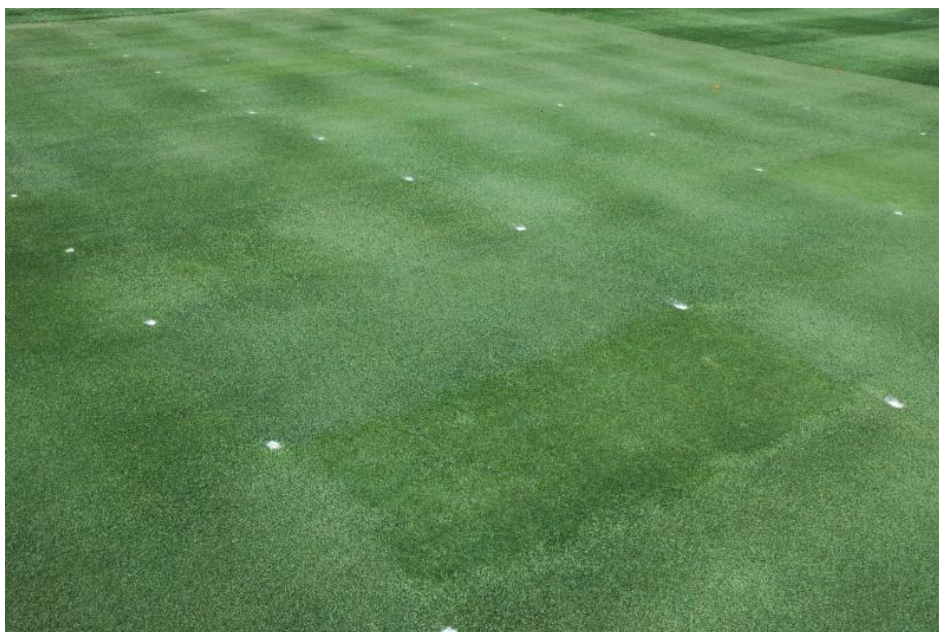

Entries in the 2008 NTEP Bentgrass Putting Green trial at Amherst, MA, Spring 2011

USGA/NTEP PUTTING GREEN TRIAL UPDATE

USGA/NTEP warm-season trial set to evaluate bermuda, zoysia and seashore paspalum for putting greens

NTEP has partnered with the USGA to establish a new putting green trial for warm-season grasses. The trial, which includes fifteen (15) bermudagrasses, eleven (11) zoysiagrasses and two (2) seashore paspalum [entries](#), contains several interesting plant types. The trial has been planted at eleven locations across the south, southwest and Transition Zone. [University researchers](#) are responsible for data collection, however, [trial locations](#) are split between golf courses and university research centers.

Trial management goals are to achieve stimpmeter readings of 9-10' while reducing inputs, as compared to ultradwarf bermudas. [Initial establishment and management parameters](#) have been developed and these will be tweaked over time.



Since shipping these entries in late June, we have received several updates from our cooperators. Here are pictures from a few sites:



**Top left: Entries at the Country Club of Virginia after seven weeks.
Top right: Tamarisk CC, Rancho Mirage, CA four weeks after planting.
Above: Three weeks after planting at Jupiter Hills Club, Tequesta, FL**

In addition, John Locker at [Xton](#) has graciously donated winter covers for six of our sites (valued at over \$7,500), to ensure that the trials are protected during this first winter of grow-in and establishment (and beyond). We really appreciate Xton's support of this project!

The warm-season putting green trial is made possible with considerable funding from the [United States Golf Association Green Section Research Program](#). We truly appreciate the support of the USGA in funding this project!

Additional updates on this trial will be provided in future issues of this newsletter.

NATIONAL ARBORETUM TURF EXHIBIT and GRASS ROOTS UPDATE

Turf exhibit groundbreaking kicks off *Grass Roots*!



Left to right: Scott Aker, National Arboretum Head Horticulturist, Kevin Morris, NTF President, Zoe Clarkwest, designer from Rain Underground, Dr. Colien Hefferan, National Arboretum director, Geoff Rinehart, Grass Roots Coordinator and Michael Stachowicz, National Mall turf manager

After two years of discussions, meetings and planning, the National Arboretum kicked off the development of the outdoor turfgrass exhibit and *Grass Roots* program with an official groundbreaking ceremony on November 15th. After speeches and presentations from several key members of the organizing, planning and development committee, Dr. Frank Rossi of Cornell University gave his vision of turfgrass in the 21st century and turf's role in environmental protection, human health, safety and quality of life issues.



Dr. Frank Rossi, Extension Turf Specialist, Cornell University speaks to over 100 participants during the *Grass Roots* groundbreaking event.

For the past several newsletters, we have outlined the development of an outdoor turfgrass exhibit to be established at the [U. S. National Arboretum](#), a 446 acre USDA, ARS research and education public

gardens facility two miles from the U.S. Capitol in Washington, DC. In addition, we have discussed the four-year focus on turfgrass entitled *Grass Roots*. *Grass Roots* will include a series of workshops, symposia and demonstrations over the four-year period, with the centerpiece of the program being the outdoor turfgrass exhibit.

Grass Roots is a unique opportunity for the turf industry to inform and educate visitors about turfgrass and the turfgrass industry. **All information presented within the 'Grass Roots' program will be science-based and reviewed by scientists in the field.** The National Arboretum is the home of many beautiful gardens and collections, as well as the Capitol Columns, the original sandstone columns from the East side of the U. S. Capitol. With over 500,000 visitors each year including members of Congress, the National Arboretum excels in research and education programs for young and old alike. Therefore, the National Arboretum is the perfect setting for the turf exhibit and the *Grass Roots* Initiative.

The design for the outdoor turfgrass exhibit component of *Grass Roots* is nearly complete, with construction starting sometime this winter, weather permitting. The exhibit features 14 elements (see the following map) with scientific review of the messaging for each element completed by a committee of scientists from the Crop Science Society of America. In addition, web-based information has been developed, including a [Question and Answer](#) document, with all of the current web information found [on the National Arboretum web site](#). The web-based information will be expanded over time.



An Initiative of the USNA and NTF Illustrative Plan for the Exhibition Site

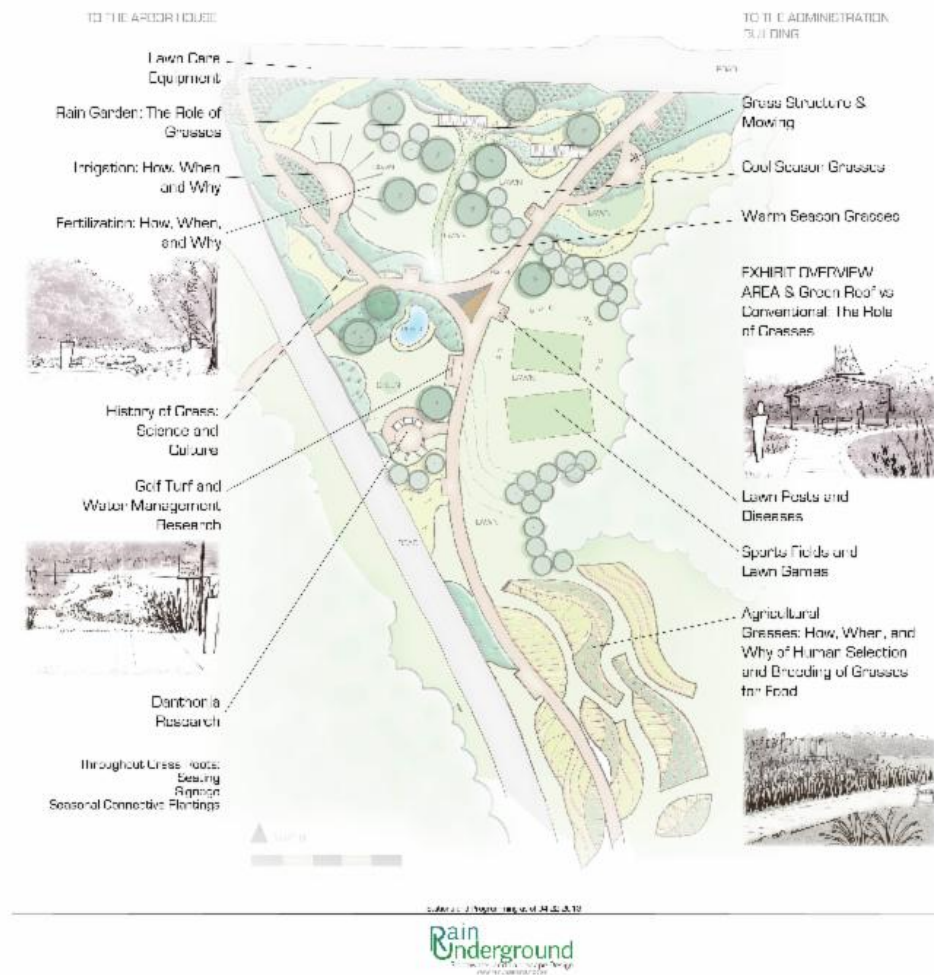

Mr. Geoffrey Rinehart started September 30th as the full-time Grass Roots Coordinator. Geoff manages all aspects of *Grass Roots* development. Follow Geoff's progress with *Grass Roots* on [f](#) at NTF Grass Roots Initiative and [t](#) Grass_Roots_NTF.

And a new collorary concept, the [National Greenscape Corridor](#), which links the National Arboretum with the [National Mall turf renovations](#) and [Arlington National Cemetery](#), is under development. All of this information can be found on the web at the [National Turfgrass Federation site](#).

The turf industry is stepping to the plate, with about \$265,000 in funds, product and services being pledged thus far to help in the development and construction of the outdoor exhibit (see our [sponsors](#)). However, we still need your help to get *Grass Roots* rolling and to provide proper maintenance for the exhibit over the four year period.

The National Arboretum is providing \$83,000 in support and service in addition to the \$265,000 pledged. That still leaves us with about \$135,000 to raise over the next 12 months.

Sponsorship opportunities are still available (see [sponsorship levels and how to donate](#)). If you have interest in financially sponsoring the outdoor exhibit, please feel free to contact me at 301-504-5125 or kmorris@ntep.org.

We hope this newsletter and future issues provide some important information that you can use in your business or job. Please feel free to contact us if you have any questions.

Sincerely,



Kevin Morris
National Turfgrass Evaluation Program



[Forward this email](#)

This email was sent to kmorris@ntep.org by kmorris@ntep.org | [Update Profile/Email Address](#) | Rapid removal with [SafeUnsubscribe™](#) | [Privacy Policy](#).



National Turfgrass Evaluation Program | BARC-West, Bldg. 005, Rm 307 | 10300 Baltimore Blvd. | Beltsville
| MD | 20705